

N1 ROLL FORMING LINE mod. PRH 14/450
for "gypsum partition" (n9 fixed & combined profiles)

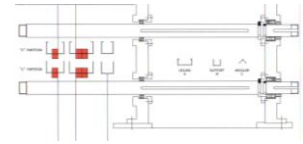

MAINS FEATURES



. Material to be processed	:	Coils
- Type	:	Mild / galvanised steel
- Max weight	Kg	: 1 500
- Maximum thickness	mm	: 1,2
- Max. production speed	m/1'	: 40/60(depends on thickness and cutting length)
. Electrical supply	V	: 400
	Hz	: 50
. Going sense	:	left/right
. Motor	a.c.	: 15 + 1,5 (electronic control by inverter)
	a.c.	: 5,5



DESCRIPTION

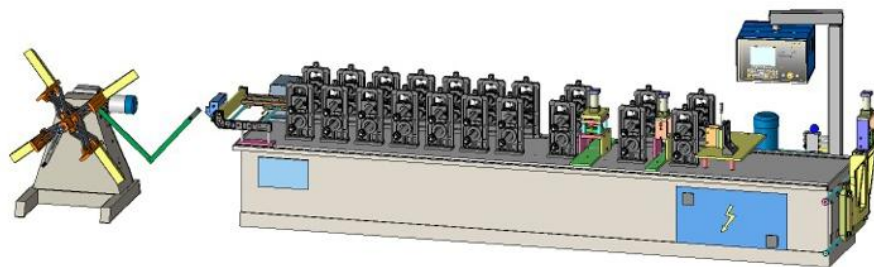

① DECOILER DMRM 315

. Capacity	Kg	:	1500
. Maximum width	mm	:	400
. Centering	mm	:	450-650
- Adjustable diskbrake			
- Manual operated centering			
- Motorization back and forth			
- Electronic control of the loop (inverter) / machine's speed			

② ROLL FORMING MACHINE PRH 14/450

. Maximum width between stands	mm	:	400
. Maximum width over stands	mm	:	250
. Diameter of shafts	mm	:	55
. Number of forming stations	N	:	10 (frame allowed for 14)
. Motor	HP	:	15

- **one piece table**, from planed steel with lining up grooves for the transmission uprights
- N10 stations with special **cast-iron stands**, housing large bearings of the best domestic and foreign brands.
- Steel roller shafts, entirely ground with 10 mm slots.
- **Upper roller shafts adjustable** according to the thickness to be worked, with graded vernier scale for setting.
- **Adjustable** introducing **guides** to line up the strips on the different sets of rolls
- Group of straighteners lined up on each set of rollers
- Geared motor (a.c. with electronic control), **HP 15** with **direct connection** to the powering's shaft
- **One piece** transmission **shaft** Ø mm 40 from the motor **to the different stations** with conical gears
- Start up directly from the main electrical panel, or from a **remote control** box with forward and backward.

🌿 *patented system – description attached* 🌿

③ ELECTRICAL EQUIPMENT AND HANGING UP ADJUSTABLE CONTROL PANEL



- . Remote control (band introduction)
- . Programmer type **EC 609 VIDEO**, with control of :
 - Speed
 - Number of pieces
 - Cutting length
 - Lubrification
 - punching - notching

④ HYDRAULIC PLANT

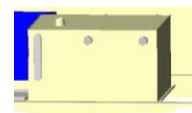

- . Tank L : 150
- . Hydraulic unit motor pump HP : 5,5

- Adjustable frame after the rolling machine, for the right positioning and lining up of the different cutting units with the suited sets of rolls.

⑤ SETS OF ROLL FORMERS in special tempered and rectified steel as drawings attached

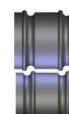

≈ sets of tooling fixed between station ≈

- N1 complete **set of roll formers + straightener** for profile **“A”** (ceiling)
- N1 complete **set of roll formers + straightener** for profile **“B”** (support)
- N1 complete **set of roll formers + straightener** for profile **“C”** (angular)

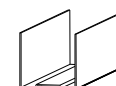
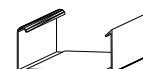

≈ sets of roll formers adjustable overhang ≈

- N1 complete **set of roll formers + straightener** for profile **“C”** stud base mm 48, 8
- N3 **couples** of final **rolls** for **“U”** runner base mm 50

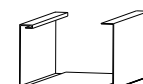

48, 8

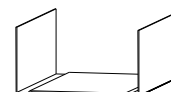

50



quick clamping spacers

- N40 **spacers** for **“C”** & **“U”** bases mm 73,8 - 75 / 98,8 - 100

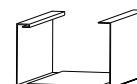

73, 8 – 98,8

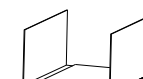

75-100

⑥ HYDRAULIC CUTTING TOOLING



- N1 complete hydraulic **cutting unit** for profiles **“A”** (ceiling) + **“B”** (support) + **“C”** (angular)
- N1 **adjustable** hydraulic **cutting unit** for **“C”** & **“U”** (n6 profiles)



48,8–73,8–98,8

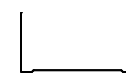

50-75-100

